

# Laser-Position-Transducer



Series LLD

***measurement range 0,1...150 m***

***resolution: 0,1mm***

***repeatability:  $\pm 0,5$  mm***

***measuring accuracy:  $\pm 3$  mm***

***output: 4...20 mA, RS232, RS422, Profibus***

***digital switch output adjustable***

***protection class IP 65***

***measuring frequencies 50/10 Hz***

***exact alignment of laser by the visible measuring beam***

***below 30 meters no reflector necessary***

***safe operation mode with laser class 2***

***applications: high rack stores, garage systems, cranes ect.***

## Technical Datas

**Measurement range:** 0,1 ... 30 m on all natural diffuse reflecting surfaces, up to 150 m on white target

**power supply:** 10...30 Vdc

**analogue output:** 4...20mA (to parameterise by RS232/RS422)

**light source:** laserdiode infrared 650 nm

**laser class:** 2, 1mW

**data interfaces:** RS 232 or RS 422

**resolution:** ±0,1 mm

**repeatability:** ±0,5 mm

**accuracy:** ±3 mm (+15...+30°C)  
±5 mm (-10...+50°C)

**frequency:** 50/10 Hz

**max. data sampling:** 0,16 to 6s (10 HZ), 20ms (50Hz)

**transfer rate RS:** 2,4 / 4,8 / 9,6 / 19,2/38,4 kbaud

**switching output:** capacity load max. 0,5A

**trigger input:** trigger 24V

**connection:** 12-pin connector

**protection:** IP65

**store temperature:** -20 °C ... +70 °C

**working temperature:** +10...+50°C

## LLD

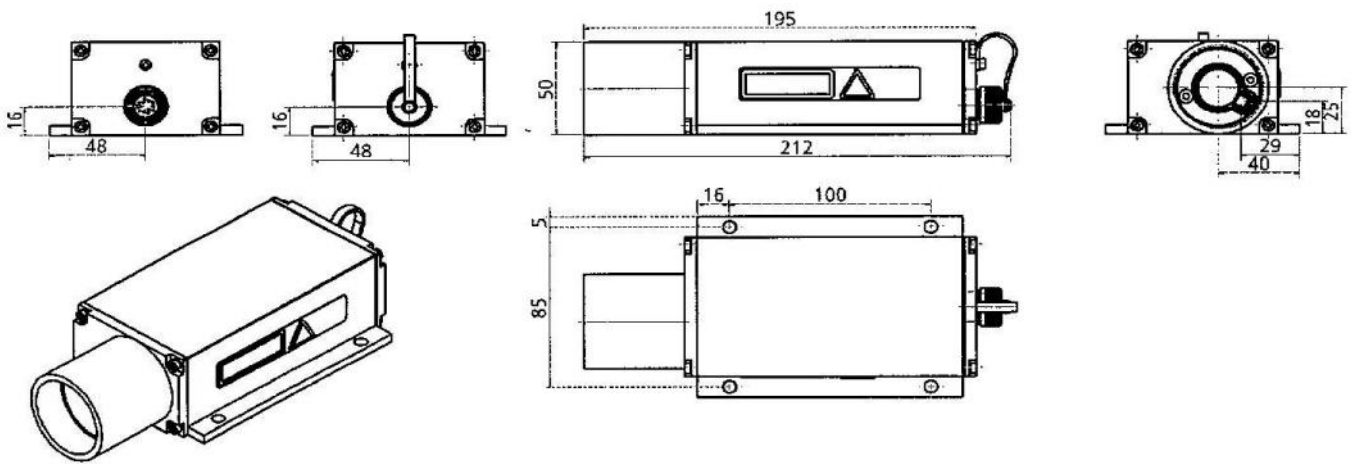

## Order Code LLD

